

10100

11

12

PROFILE - SIERRA WAY
Scale: Horiz. 1" = 20'
Vert. 1" = 2'

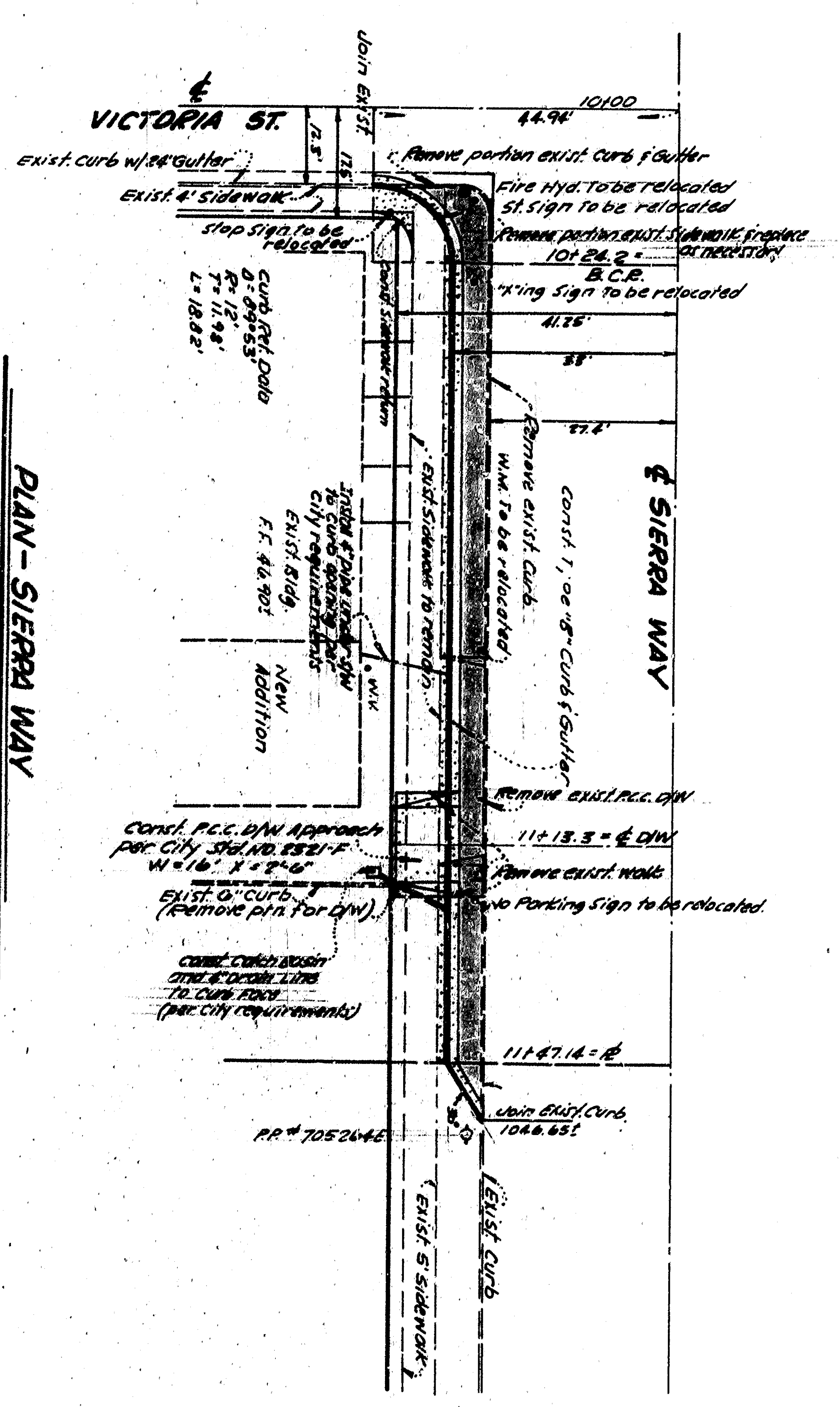
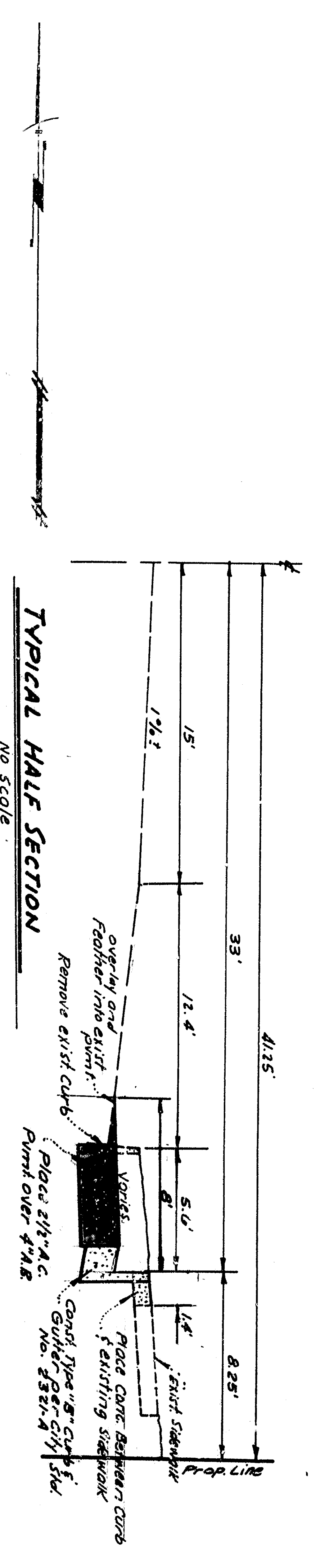

PLAN - SIERRA WAY
Scale: 1" = 20'
NOTE: Existing sidewalk to be replaced as directed by city engineer.

GENERAL NOTES:

1. All work embodied on this plan shall be done in conformity with applicable provisions of Standard Specifications as they revised Nov. 1944 & Std. Drawg. 2. Section work - Sierra Way, Station 1045+00 to 1046+00.

APPROVED	1966	REGISTERED CIVIL ENGINEER	NESTE, BRUDIN & STONE CIVIL ENGINEERS 137 W. Fifth St. San Bernardino Calif. Reg. No. 8618
DRAWING NO.	3200	DRAWN BY	San Bernardino
CHECKED BY		CITY OF SAN BERNARDINO	
SHEET 1 OF 1		DEPARTMENT OF ENGINEERING	
		SIERRA WAY & VICTORIA	
		Curb, Gutter and Paving	

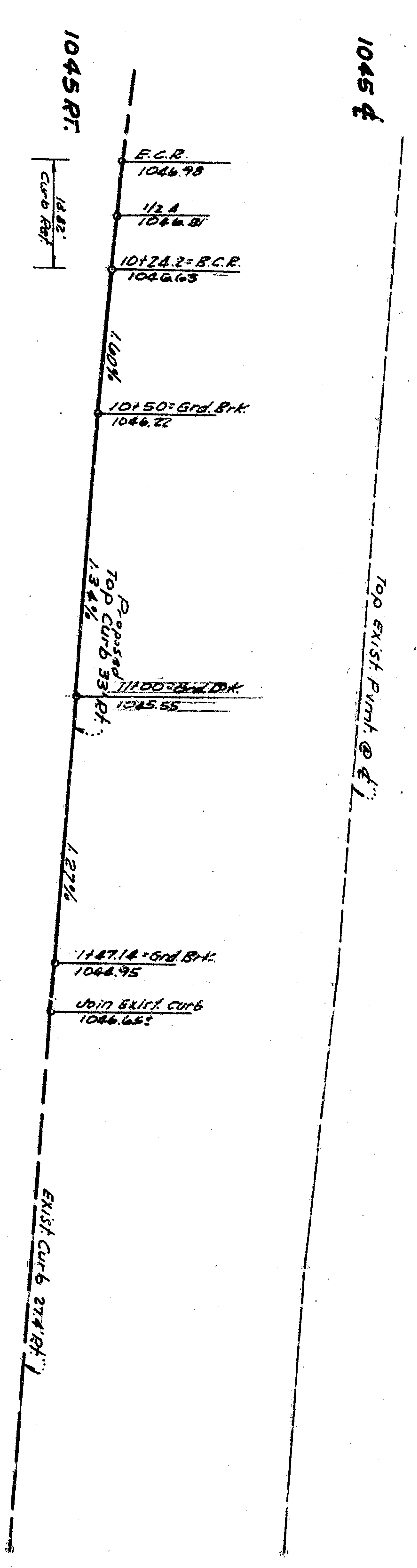

10100

11

12

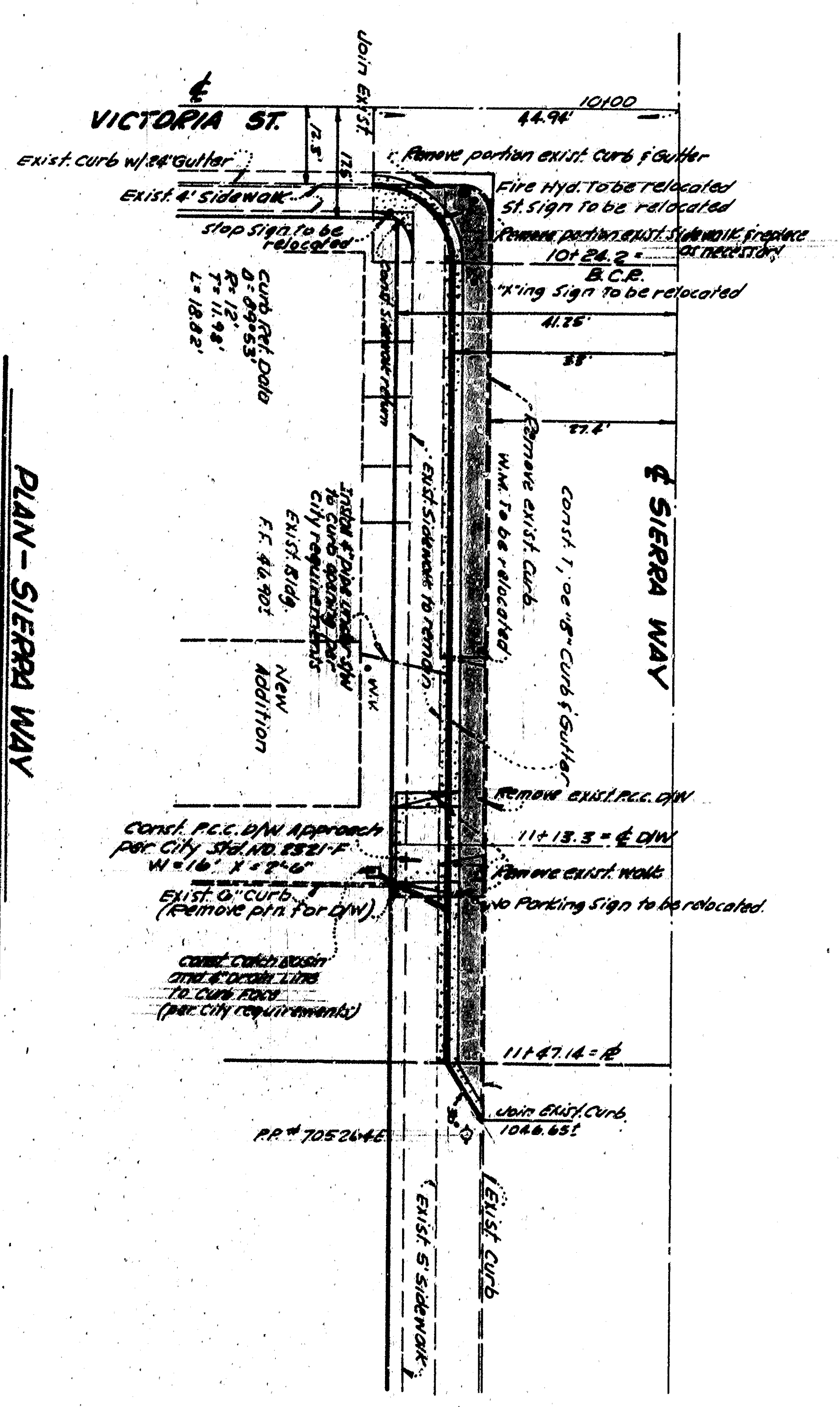
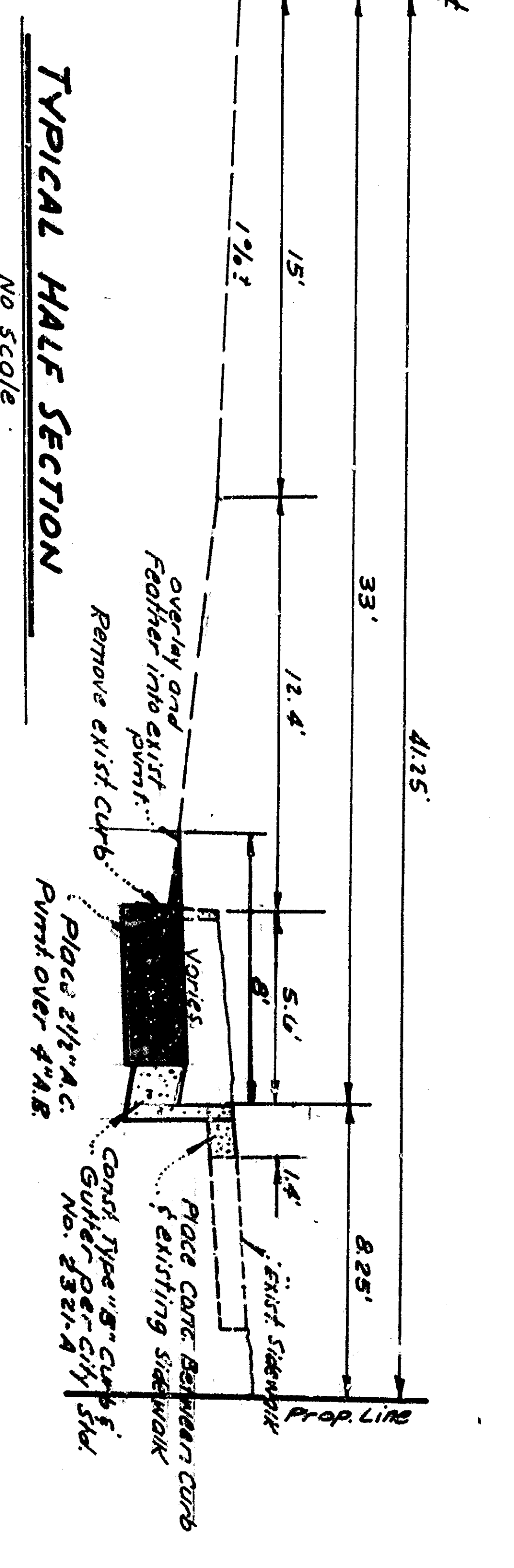

NOTE: Existing sidewalk to be repaired as directed by city engineer.

GENERAL NOTES:

1. All work embodied on this plan shall be done in conformity with applicable provisions of Standard Specifications as they revised Nov. 1944 & Std. Drawg. & Section work. See W. Section 5741, 5742, & 5743.

APPROVED	1966	REGISTERED CIVIL ENGINEER
DRAWING NO.	3200	CHECKED BY
SHEET 1 OF 1		RECOMMENDED
CITY OF SAN BERNARDINO DEPARTMENT OF ENGINEERING		
SIERRA WAY & VICTORIA		
Curtis-Gardner and Paving		